



Motorized Paperless Interactive Monitor Lift TS-F173ZMT3

Embedded software: paperless conference terminal client software V3.045



Description

The integrated design of the lift and the array microphone, without back board connection, looks neat and elegant. It can work with the paperless conference terminal to display the required patterns and other information. The machine can perfectly realize the powerful interactive paperless conference function with the array microphone.

Feature

- * The machine adopts an all-aluminum structure, high-quality aluminum material and CNC engraving processing treatment; the overall display frame and the cabinet adopt aluminum alloy, making the overall machine exquisite, light, beautiful.
- * The surface of the machine is anodized and looks bright.
- * The panel is space-saving with 3mm in thickness only. It is only one-third weight of the conventional lift, which reduces transportation cost and the pressure of conference table.
- * The transmission structure is specially treated to minimize the noise; it adopts high-quality stretch-resistant belts, high-precision sliding guide rail and linear bearings, and AC gear motor as the driving power; the central control protocol, with strong compatibility, can be compatible with all computer controllers. The screen is powered on when turning up, and is powered off when turning down, which is environment friendly.
- * Support HDMI and VGA two-channel signal input. When there is only one signal input, the screen will automatically recognize the signal. When two signals are input at the same time, it can be manually switched through the panel buttons. When no signal input, the screen will automatically enter power saving mode.
- * This machine can be centrally controlled by the central control software and the controller. One key can make all the machines in the room go up or down.
- * The microphone uses a 48KHz sampling rate, better than the CD sound quality, clear and bright sound, without the low-frequency impact sound.
- * The delegate unit has the function of applying for speech, and the application can be approved by the chairman unit with a screen or with a "3" key, or by the PC software.
- * 5-band EQ adjustment function, can adjust different sound effects according to the voice characteristics of the speaker until the perfect effect is achieved.
- * The chairman unit has a priority function, which can turn off all delegate unit that are speaking.
- * Use 100M network transmission to realize hand-in-hand cascade; long-distance transmission will not have any impact on sound quality.
- * Non-gooseneck microphone pickup, the array pickup distance can reach 60cm. Good directivity, cystic pickup area, effectively avoid the surrounding noise pickup.
- * Electric flip structure, which can be flipped up when speaking, and down when not speaking. It can be controlled by buttons or unified management by the controller and PC software.



Motorized Paperless Interactive Monitor Lift TS-F173ZMT3

Embedded software: paperless conference terminal client software V3.045

Specification

Screen	Touch control
Power supply	AC 220V 50-60/HZ
Lifting time	30S
Elevation angle	30
Product size	476*130*565mm
Cabinet size	461*126*562mm
Panel size	476*130*3mm
Desktop opening size	463*127mm (recommended to open hole according to the actual product)
Panel sinking size	477*131*3mm (L*W*T) (recommended to open hole according to the actual product)
Environment conditions	-20°C ~ 50°C humidity≤70%
Screen size	17.3 inches
Screen ratio	16 : 9
Screen resolution	1920*1080P
Video port	VGA, HDMI
Video switching	VGA, HDMI (switch manually)
Screen contrast	700:1 (Typ.) (TM)
Screen brightness	300 cd/m ² (Typ.)
Viewing angle	89/89/89/89 (Typ.)(CR≥10)
Signal system	EDP
Power consumption	20W

Array Microphone

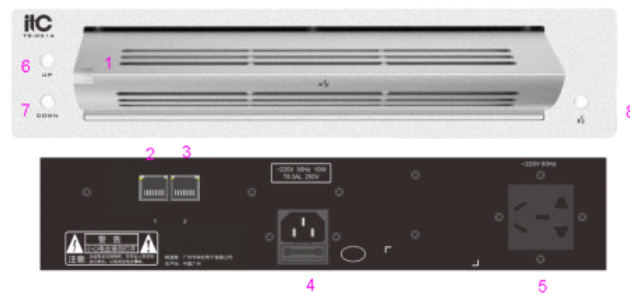

Feature

- * Microphone status indicator;
- * Connect to the port of the previous conference unit;
- * Connect to the port of the next conference unit;
- * 220V power input port of AC power supply;
- * 220V power output port of AC power supply;
- * UP button: turn up the microphone;
- * DOWN button: turn down the microphone;
- * ON/OFF button: turn on/off the microphone.



Array microphone Specification

Microphone type	ECM array wired microphone
Number of microphone cores	13
Frequency response	80Hz~16KHz
Microphone input impedance	200Ω
Sensitivity	-30dB (0dB=1V/pa , @1kHz)
Signal to noise ratio	>80dB(A)
Dynamic Range	>80dB
Maximum SPL	112dB (THD≤0.5% , @1KHz)
THD	<0.1%
Directivity	Corridor type
Connector	Network port
Power supply	Host power supply, AC power supply 220V power supply
Sign-in function	Key sign in

Product Dimensions

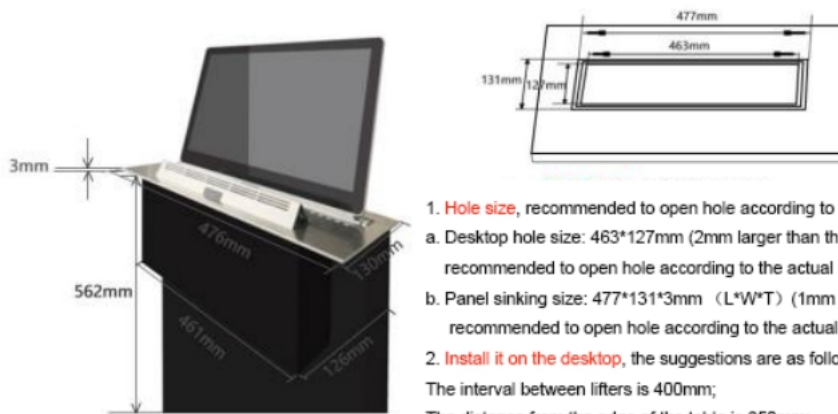

- Hole size**, recommended to open hole according to the actual product:
 - Desktop hole size: 463*127mm (2mm larger than the ractual product, recommended to open hole according to the actual product)
 - Panel sinking size: 477*131*3mm (L*W*T) (1mm larger than the actual product, recommended to open hole according to the actual product)
- Install it on the desktop**, the suggestions are as follows
The interval between lifters is 400mm;
The distance from the edge of the table is 350mm;
The distance can be adjusted appropriately according to the actual needs of the site.